

# GLOBAL WIND ORGANISATION (GWO) BASIC SAFETY TRAINING STANDARDS (BST)

---

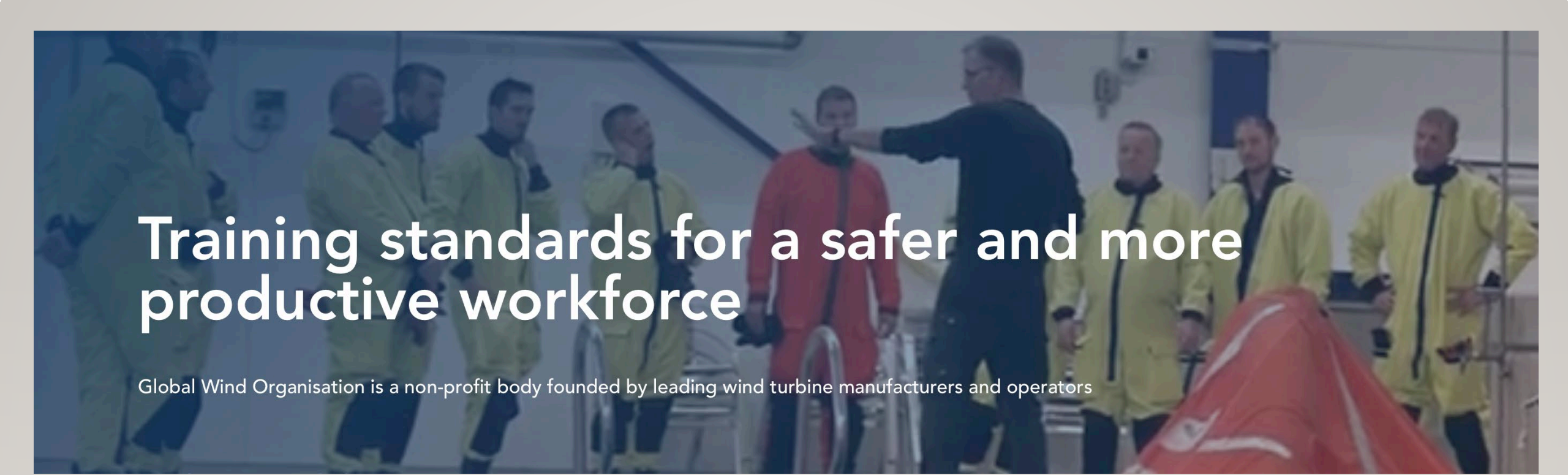

GLOBAL WIND  
ORGANISATION



# Training standards for a safer and more productive workforce

Global Wind Organisation is a non-profit body founded by leading wind turbine manufacturers and operators



GLOBAL WIND  
ORGANISATION

# BASIC SAFETY TRAINING STANDARD (BST)

---

GWO BST training will enable participants to support and care for themselves and others working in the industry by possessing the knowledge and skills of first aid, working at heights, manual handling, fire awareness, sea survival and in case of an emergency, to be able to evacuate, rescue and provide appropriate first aid to casualties.



GLOBAL WIND  
ORGANISATION



# FIRST AID MODULE

---

The aim of the First Aid Module is to enable participants, through theoretical and practical training, to recognize signs and symptoms of life threatening situations and administer safe and effective first aid in the wind turbine environment in order to save lives and prevent further injury, until the casualty can be handed over to the next level of care.



GLOBAL WIND  
ORGANISATION

# FIRST AID MODULE

---

After having successfully completed this First Aid Module, the participants will have the ability to:

- 1) Act independently in recognizing, assessing, and prioritizing the need for basic first aid and providing lifesaving first aid until the casualty can be handed over to the next level of care in case of an incident in the wind turbine environment.
- 2) Take responsibility for recognizing their limitations as a basic first aider, calling for help and enable evacuation off the casualty in case of an incident in the wind turbine environment.



GLOBAL WIND  
ORGANISATION

# MANUAL HANDLING MODULE

---

The aim of this module is to reduce the risk of musculoskeletal injuries for workers in the wind industry and enable participants to perform their tasks and activities in the safest possible way when working in a wind turbine environment.

After having successfully completing this Manual Handling module, the participants will have the ability to take responsibility for the use of essential manual handling principles to reduce the risk of musculoskeletal injury when performing physical tasks and activities in the wind industry.



GLOBAL WIND  
ORGANISATION

# FIRE AWARENESS MODULE

---

The aim of this module is to enable the participants to prevent fires, make appropriate judgements when evaluating a fire, manage evacuation of personnel and ensure all are safely accounted for in the event of an unmanageable fire. If the incident is judged to be safe, the participants should be able to efficiently extinguish an initial fire by using basic handheld firefighting equipment.



GLOBAL WIND  
ORGANISATION



# FIRE AWARENESS MODULE

---

Overall learning objectives:

- 1) The participants can act independently to identify fire hazards and prevent fires in a wind turbine environment.
- 2) The participants can take responsibility for assessing a fire and, if needed, be able to select the right extinguishing media according to the fire classes.
- 3) The participants can take responsibility for the evacuation of personnel and ensure all are safely accounted for in the event of an unmanageable fire.
- 4) The participants can act independently in efficiently extinguishing an initial fire by using basic handheld firefighting equipment, if the incident is judged to be safe.



GLOBAL WIND  
ORGANISATION



# WORKING AT HEIGHTS MODULE

---

The aim of this module is to enable the participants, through theoretical and practical training, to use basic personal protective equipment, work safely at heights and perform comprehensive basic rescue from heights in a remote wind turbine environment. This course is not designed to test the participants' capability and aptitude for working at height, i.e. It is not a test for fear of heights.

After having successfully completing this Working at Heights Module, the participants have the ability to act safely and responsibly when using basic personal protective equipment, working at heights and performing comprehensive basic rescue from heights in a remote wind turbine environment.



GLOBAL WIND  
ORGANISATION

# SEA SURVIVAL MODULE

---

The aims of this module are, by theoretical and practical training, to give the participants the ability to act safely and responsibly and to take the correct preventive actions in all aspects of offshore operations from shore to installation vessel and vice versa. This is both during normal operations and in an offshore wind energy environment emergency.



GLOBAL WIND  
ORGANISATION

# PARTNERSHIPS:

---



# PARTNERSHIPS:

## EMPIRE STATE UNIVERSITY

---

This proposed training program will be part of a “Workplace Safety Program for the Offshore Wind Industry,” jointly run by the Educational and Cultural Trust Fund of the Electrical Industry and the Harry Van Arsdale Jr. School of Labor Studies (HVASLS) at SUNY Empire. HVASLS will develop a curriculum to be used as an introduction to the 40-hour wind safety training individuals will receive from the Educational and Cultural Trust Fund.





## PARTNERSHIPS:

### VINCI - VR

---

Delivering high-quality virtual reality simulations. With decades of simulation and gaming experience, Vinci's team specializes in producing world-class virtual reality (VR) simulations.

Making Virtual Reality Accessible, Vinci VR is on a mission to bring accessible and affordable VR simulations and experiences to the world by using cutting-edge technologies such as 3D scanning and open libraries of content.

# Virtual Reality Solutions For The Offshore Wind Industry

Bringing offshore wind to life with cutting-edge simulations and virtual reality experiences. Whether you're looking for a solution to community engagement, workforce training, or making a memorable impression at trade shows, we're your VR partner.

VINCI

Unlocking the potential  
of VR for high-skill  
training in offshore  
wind.

# PARTNERSHIPS: IWNL ENERGY

---



IWNL Energy is a world-renowned provider of innovative training, workshops, and consulting services for individuals, organizations, and communities seeking to enter or expand in the renewable energy sector. We are at the forefront of the industry, constantly staying ahead of the latest trends and technologies to ensure our clients have the knowledge and skills needed for success. With our expert guidance, your organization will become a leader in the renewable energy revolution. Dr. Cynthia Brown, is a trailblazer in the industry with over two decades of experience providing expert guidance to clients across various sectors, including renewable energy, aerospace & defense, manufacturing, and education. Her unique expertise in sustainable energy solutions and workforce development has made her a respected voice within her field.

# PARTNERSHIPS: RELYON NUTEC

---

Relyon Nutec is a global business delivering safety and competence services across the world, helping customers protect their people, assets and the environment. With headquarters in Copenhagen and a global footprint, Relyon Nutec has a deep history in delivering compliance and competence services going back over 50 years.

**RelyOn Nutec**  
360° Safety

**Your global partner for safety critical industries**  
- we support you saving lives and protecting the  
environment



# PARTNERSHIPS: SEFTEC GROUP

---

We help our clients achieve the best possible solution for their training facility in the most cost-efficient and timely manner by developing customized solutions based on their exact requirements. From facility design through to certification, we can help you throughout every stage of the build process.

As the global leader in the supply of sea survival training facilities, whether GWO, OPITO or military, we can supply everything from the pool and platforms to hoists and HUET.

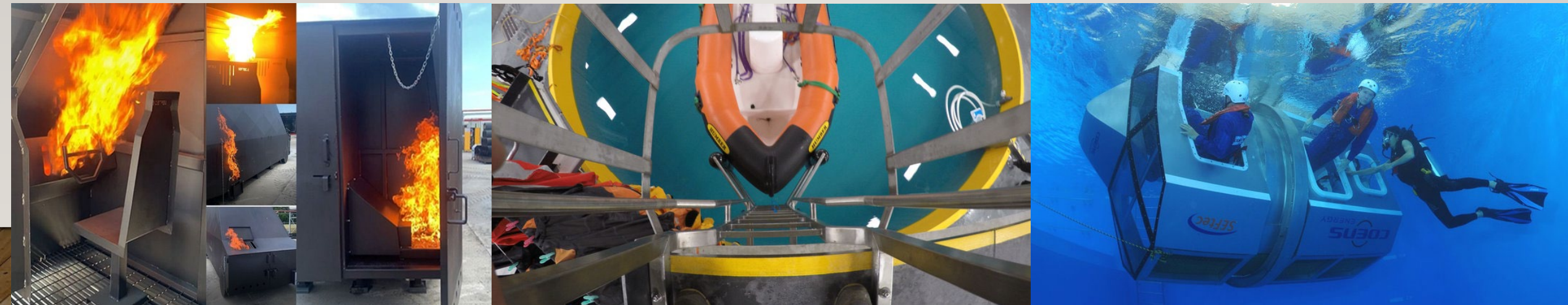



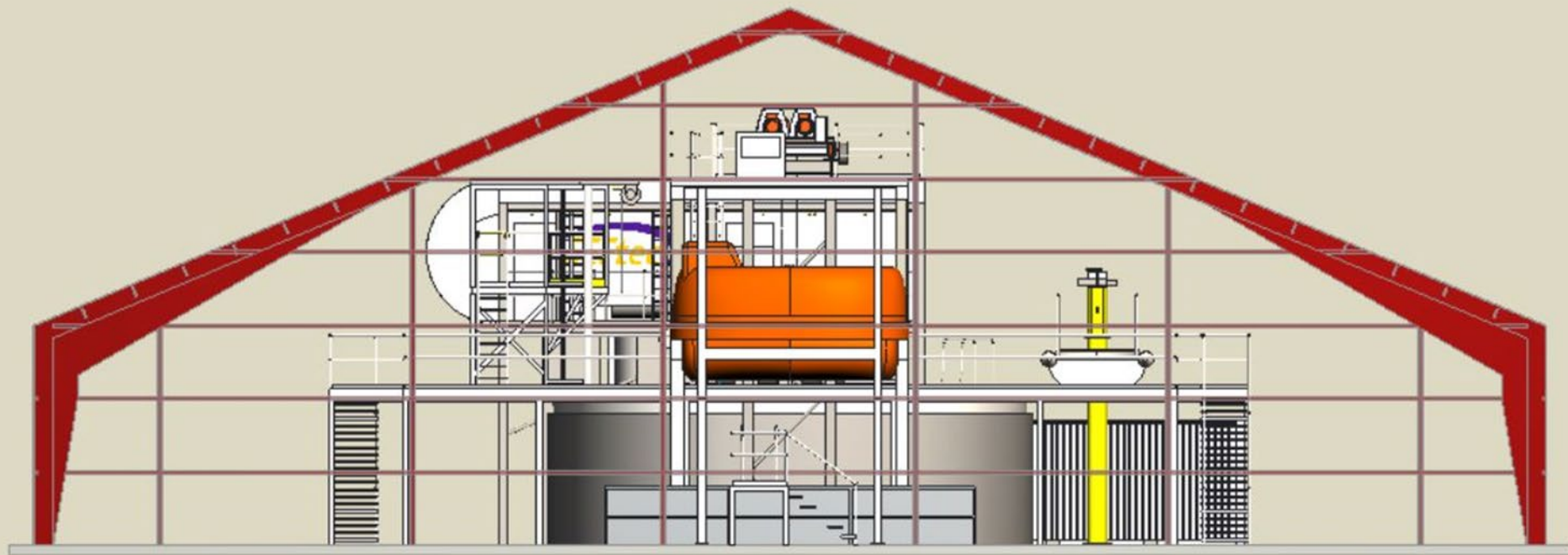



BUILDING





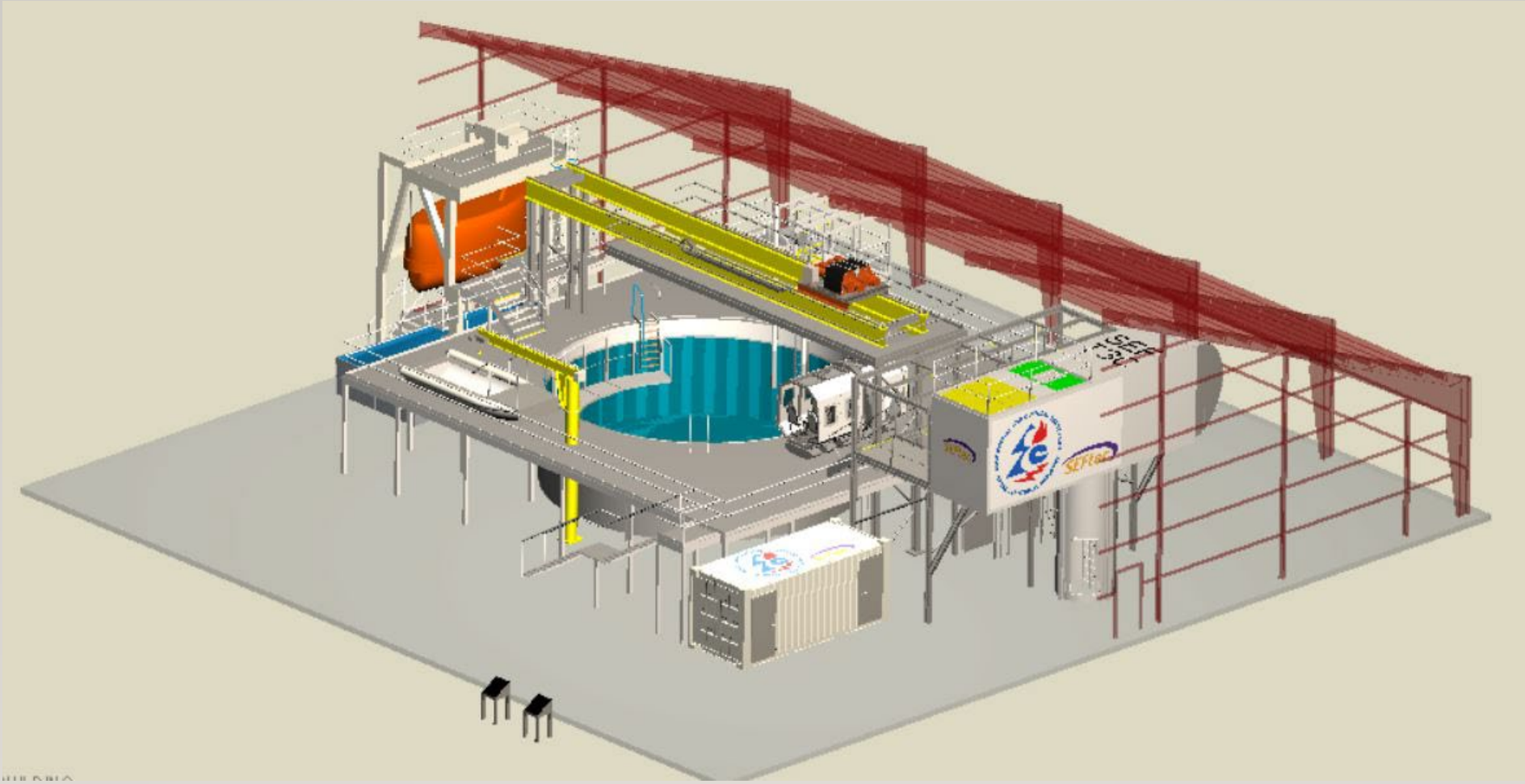

SEPLA

This unit contains all the elements required for the Global Wind Organization (GWO) basic and advanced training standards.

These include:

- Training pool and deck
- Life raft and jib
- Crew transfer vessel and docking ladder
- Heli winch platform
- Wind turbine tower, with internal ladders, basement and landings
- Wind turbine nacelle and hub with internal obstacles, escape hatches, confined spaces and small fire
- Training ladders





As well as GWO training, the capabilities to include pool based Offshore Petroleum Industry Training Organization (OPITO) training, Standards of Training and Certification of Watchkeeping (STCW) training, Helicopter Underwater Escape Training (HUET).



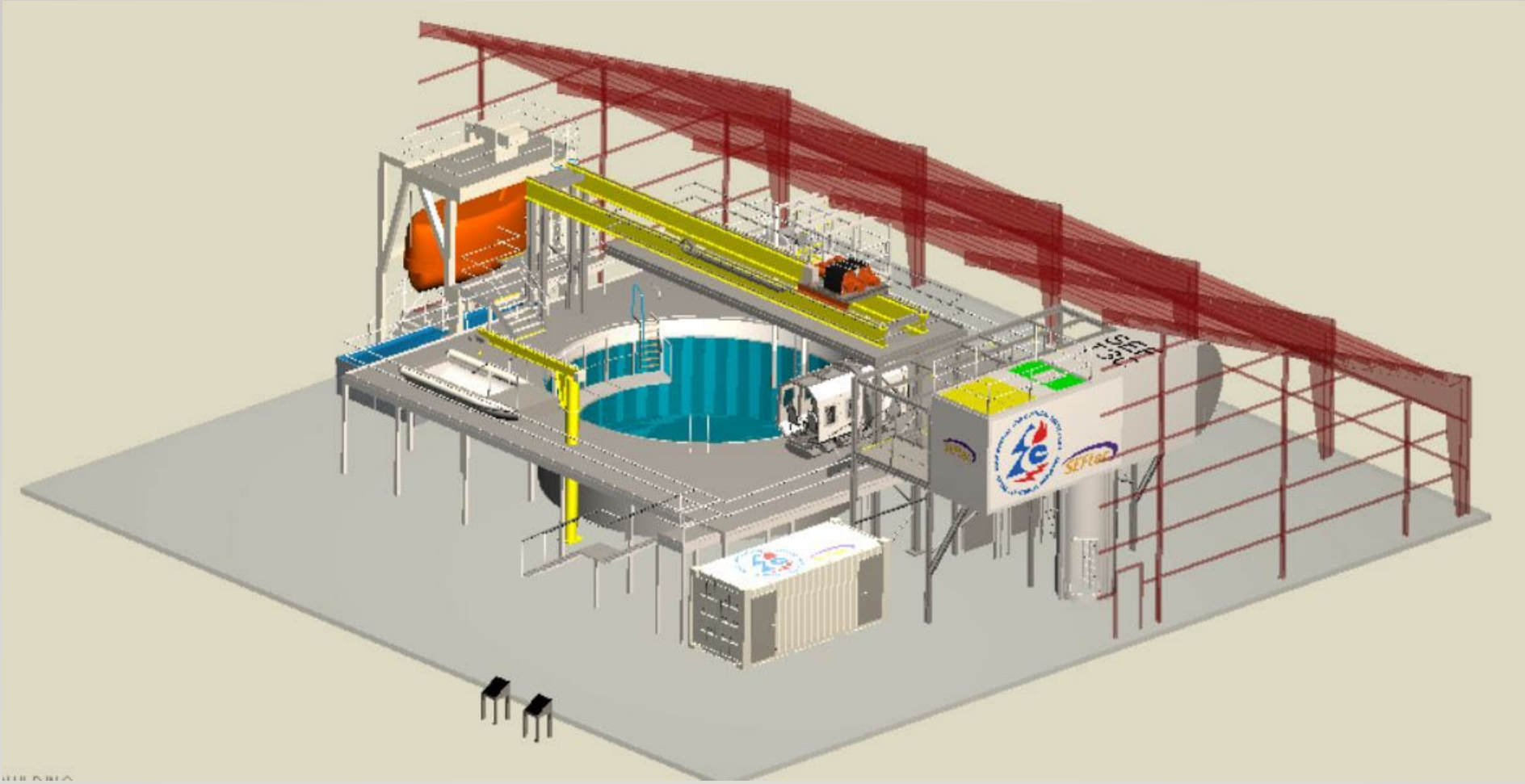

www.sefira.com